

Power inductors RH0703-1209 系列

◆ Features

Various high power inductors are superior to be high saturation for surface mounting.

◆ Applications

Power supply for VTR,OA equipment Digital camera,LCD television set notebook PC, portable communication equipments,DC/DC converters,etc.



| Type (型式) | A | B | C(max) | D | |
|-----------|----------------|----------------|----------------|-----|--|
| PWDR0301 | 3.5 ± 0.3 | 3.0 ± 0.3 | 1.15 ± 0.3 | 1.0 | |
| PWDR0302 | 3.5 ± 0.3 | 3.0 ± 0.3 | 2.1 ± 0.3 | 1.0 | |
| PWDR0402 | 4.5 ± 0.3 | 4.0 ± 0.3 | 2.1 ± 0.3 | 1.4 | |
| PWDR0403 | 4.5 ± 0.3 | 4.0 ± 0.3 | 3.2 ± 0.3 | 1.2 | |
| PWDR0502 | 5.8 ± 0.3 | 5.2 ± 0.3 | 2.1 ± 0.3 | 1.3 | |
| PWDR0503 | 5.8 ± 0.3 | 5.2 ± 0.3 | 3.2 ± 0.3 | 2.0 | |
| PWDR0504 | 5.8 ± 0.3 | 5.2 ± 0.3 | 4.5 ± 0.3 | 1.6 | |
| PWDR0703 | 7.8 ± 0.3 | 7.0 ± 0.3 | 3.5 ± 0.4 | 3.0 | |
| PWDR0705 | 7.8 ± 0.3 | 7.0 ± 0.3 | 5.0 ± 0.4 | 3.0 | |
| PWDR1004 | 10.0 ± 0.3 | 10.0 ± 0.3 | 4.0 ± 0.5 | 2.1 | |
| PWDR1005 | 10.0 ± 0.3 | 10.0 ± 0.3 | 5.4 ± 0.5 | 3.0 | |

SCHEMATICS

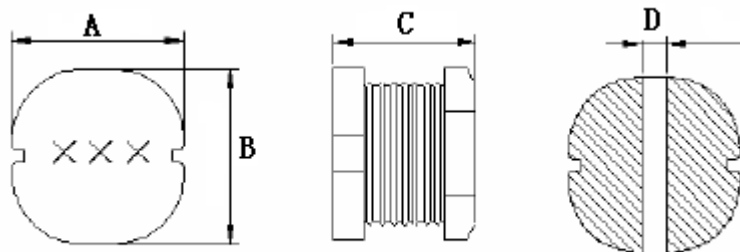



<http://www.fpe.com.cn>

| Part Number (品名) | Inductance (μ H) (电感值) | DCR(max) (Ω) (直流阻抗) | IDC(A) (max) $\Delta L/L=-35\%$; $\Delta t=40^{\circ}\text{C}$ (额定电流) | Test Freq. (测试频率) |
|---------------------|-----------------------------------|---------------------------------|--|----------------------|
| PWDR0301 | 0.33 μ H~ 390 μ H | 0.65 Ω ~26.0 Ω | 0.10A~0.45A | 100KHz/0.25V |
| PWDR0302 | 10 μ H~390 μ H | 0.23 Ω ~7.8 Ω | 0.115A~0.76A | 100KHz/0.25V |
| PWDR0402 | 1 μ H~470 μ H | 0.030 Ω ~7.78 Ω | 0.15A~2.5A | 100KHz/0.25V |
| PWDR0403 | 1 μ H~1700 μ H | 0.033 Ω ~22 Ω | 0.04A~3.8A | 100KHz/0.25V |
| PWDR0502 | 2.2 μ H~270 μ H | 0.07 Ω ~4.3 Ω | 0.18A~3.5A | 100KHz/0.25V |
| PWDR0503 | 1 μ H~1000 μ H | 0.03 Ω ~8.0 Ω | 0.13A~4.5A | 100KHz/0.25V |
| PWDR0504 | 1 μ H~1000 μ H | 0.015 Ω ~4.8 Ω | 0.14A~5.9A | 100KHz/0.25V |
| PWDR0703 | 10 μ H~330 μ H | 0.08 Ω ~1.5 Ω | 0.28A~1.44A | 100KHz/0.25V |
| PWDR0705 | 10 μ H~470 μ H | 0.07 Ω ~1.96 Ω | 0.34A~2.3A | 100KHz/0.25V |
| PWDR01004 | 10 μ H~560 μ H | 0.053 Ω ~1.904 Ω | 0.24~2.6A | 100KHz/0.25V |
| PWDR1005 | 10 μ H~820 μ H | 0.015 Ω ~2.55 Ω | 0.24A~2.6A | 100KHz/0.25V |

TaiWan Kinji Technology Limited

TEL:+886-3-3310896

FAX:+886-3-3310865

DongGuan Meixin Technology Co.,Ltd

TEL:+86-769-86761589

FAX:+ 86-769-86761549

ShangHai Qinshen Technology Co.,Ltd

TEL:+86-798-2620089

FAX:+ 86-798-2620186

FPE-A-2 (2010.10)